

### Serie-HS Coples Hidráulicos

#### Serie-HS Niple Intercambio ISO-B Para Vapor (Rosca Hembra)

Medida	Detalle			Medida		D.E. Máximo		Hex pulg.
	# de Parte	Roscas	Material	pulg.	mm.	pulg.	mm.	
1/4"	HS2F2	1/4" - 18 NPTF	Acero	1.55	39.4	0.83	21.1	3/4"
	HS2F2-B	1/4" - 18 NPTF	Latón	1.55	39.4	0.83	21.1	3/4"
	HS2F2-S	1/4" - 18 NPTF	A.I. 303	1.55	39.4	0.83	21.1	3/4"
	HS2BF2	1/4" - 19 BSPP	Acero	1.55	39.4	0.83	21.1	3/4"
	HS2BF2-B	1/4" - 19 BSPP	Latón	1.55	39.4	0.83	21.1	3/4"
	HS2BF2-S	1/4" - 19 BSPP	A.I. 303	1.55	39.4	0.83	21.1	3/4"
3/8"	HS3F3	3/8" - 18 NPTF	Acero	1.70	43.2	0.97	24.6	7/8"
	HS3F3-B	3/8" - 18 NPTF	Latón	1.70	43.2	0.97	24.6	7/8"
	HS3F3-S	3/8" - 18 NPTF	A.I. 303	1.70	43.2	0.97	24.6	7/8"
	HS3BF3	3/8" - 19 BSPP	Acero	1.70	43.2	0.97	24.6	7/8"
	HS3BF3-B	3/8" - 19 BSPP	Latón	1.70	43.2	0.97	24.6	7/8"
	HS3BF3-S	3/8" - 19 BSPP	A.I. 303	1.70	43.2	0.97	24.6	7/8"
1/2"	HS4F4	1/2" - 14 NPTF	Acero	1.94	49.3	1.17	29.7	1-1/16"
	HS4F4-B	1/2" - 14 NPTF	Latón	1.94	49.3	1.17	29.7	1-1/16"
	HS4F4-S	1/2" - 14 NPTF	A.I. 303	1.94	49.3	1.17	29.7	1-1/16"
	HS4BF4	1/2" - 14 BSPP	Acero	1.94	49.3	1.17	29.7	1-1/16"
	HS4BF4-B	1/2" - 14 BSPP	Latón	1.94	49.3	1.17	29.7	1-1/16"
	HS4BF4-S	1/2" - 14 BSPP	A.I. 303	1.94	49.3	1.17	29.7	1-1/16"
3/4"	HS6F6	3/4" - 14 NPTF	Acero	2.41	61.2	1.44	36.6	1-5/16"
	HS6F6-B	3/4" - 14 NPTF	Latón	2.41	61.2	1.44	36.6	1-5/16"
	HS6F6-S	3/4" - 14 NPTF	A.I. 303	2.41	61.2	1.44	36.6	1-5/16"
	HS6BF6	3/4" - 14 BSPP	Acero	2.41	61.2	1.44	36.6	1-5/16"
	HS6BF6-B	3/4" - 14 BSPP	Latón	2.41	61.2	1.44	36.6	1-5/16"
	HS6BF6-S	3/4" - 14 BSPP	A.I. 303	2.41	61.2	1.44	36.6	1-5/16"
1"	HS8F8	1" - 11-1/2 NPTF	Acero	2.87	72.9	1.79	45.5	1-5/8"
	HS8F8-B	1" - 11-1/2 NPTF	Latón	2.87	72.9	1.79	45.5	1-5/8"
	HS8F8-S	1" - 11-1/2 NPTF	A.I. 303	2.87	72.9	1.79	45.5	1-5/8"
	HS8BF8	1" - 11 BSPP	Acero	2.87	72.9	1.79	45.5	1-5/8"
	HS8BF8-B	1" - 11 BSPP	Latón	2.87	72.9	1.79	45.5	1-5/8"
	HS8BF8-S	1" - 11 BSPP	A.I. 303	2.87	72.9	1.79	45.5	1-5/8"

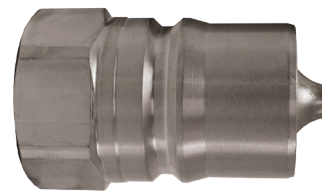

Acero

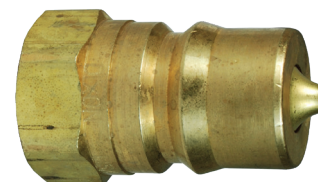

Latón



Acero inoxidable 303

