

Férulas I-Line/Q-Line

Férula Hembra I-Line Corta Soldable - 15WI

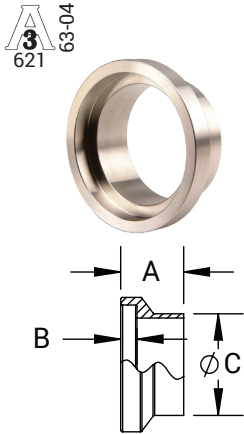

D.E. Tubing	A (in)	B (in)	C (in)	Acero Inoxidable 304 # de Parte	Acero Inoxidable 316L # de Parte
1"	.79	.25	1.00	15WI-G100	15WI-R100
1-1/2"	.95	.25	1.50	15WI-G150	15WI-R150
2"	1.04	.31	2.00	15WI-G200	15WI-R200
2-1/2"	1.16	.36	2.50	15WI-G250	15WI-R250
3"	1.22	.36	3.00	15WI-G300	15WI-R300
4"	1.35	.36	4.00	15WI-G400	15WI-R400
6"	1.13	.24	6.00	---	15WI-R600
8"	1.13	.24	8.00	---	15WI-R800

Férula Hembra I-Line Larga Soldable - 15WLI

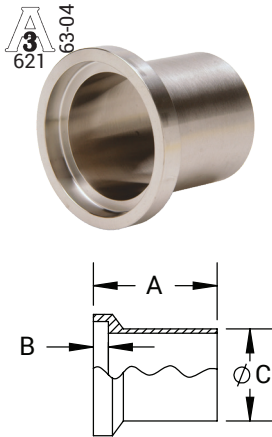

D.E. Tubing	A (in)	B (in)	C (in)	Acero Inoxidable 304 # de Parte	Acero Inoxidable 316L # de Parte
1"	1.75	.25	1.00	15WLI-G100	15WLI-R100
1-1/2"	2.03	.25	1.50	15WLI-G150	15WLI-R150
2"	2.31	.31	2.00	15WLI-G200	15WLI-R200
2-1/2"	2.50	.36	2.50	15WLI-G250	15WLI-R250
3"	2.69	.36	3.00	15WLI-G300	15WLI-R300
4"	3.00	.36	4.00	15WLI-G400	15WLI-R400
6"	3.00	.24	6.00	---	15WLI-R600

Férula Hembra I-Line Soldable para Tanque de Muro Pesado - 15WHI

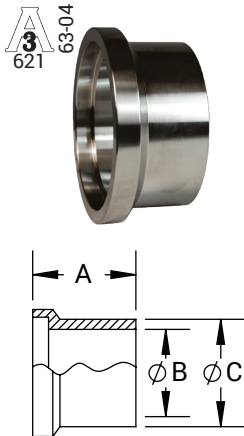

D.E. Tubing	A (in)	B (in)	C (in)	Acero Inoxidable 304 # de Parte	Acero Inoxidable 316L # de Parte
1"	1.50	.87	1.25	15WHI-G100	15WHI-R100
1-1/2"	1.63	1.37	1.69	15WHI-G150	15WHI-R150
2"	1.75	1.87	2.25	15WHI-G200	15WHI-R200
2-1/2"	1.75	2.37	2.75	15WHI-G250	15WHI-R250
3"	1.81	2.87	3.31	15WHI-G300	15WHI-R300
4"	2.13	3.83	4.25	15WHI-G400	15WHI-R400

N